



**Please draw on the sample site plan below:**

- Existing sewer pipe line location, new sewer pipe line or section location, location of spot of repair, Backwater valve location, Cleanout and location of street connection.
- Provide dimensions of pipeline from fixed structures and/or property line (Ex. House, street, property line, curb)

**Note: Backwater valve may be required depending on location of street upper main sewer man hole.**

**\* Dimensions of existing sewer pipe**

Length	Diameter
<input type="text"/>	<input type="text"/>

**\* Type of pipe**

**\* Depth of pipe at household**

**\* Depth of pipe mid-yard**

**\* Depth of sewer lateral connection**

**\* Dimension of new sewer pipe**

Length	Diameter
<input type="text"/>	<input type="text"/>

**\* Type of new pipe**

**\* Dimension of connecting street pipe**

Diameter

**\*Type of pipe**

**\* Depth of pipe at Street**



Please draw on the sample site plan below:

- Existing sewer pipe (lateral) line location, new sewer lateral or section location, location of spot of repair, backwater valve location, cleanout and location of street connection.
- Provide dimensions of lateral from fixed structures and/or property line (Ex. house, street, property line, curb)

**Note:** Backwater valve may be required depending on location of street upper main sewer man hole.

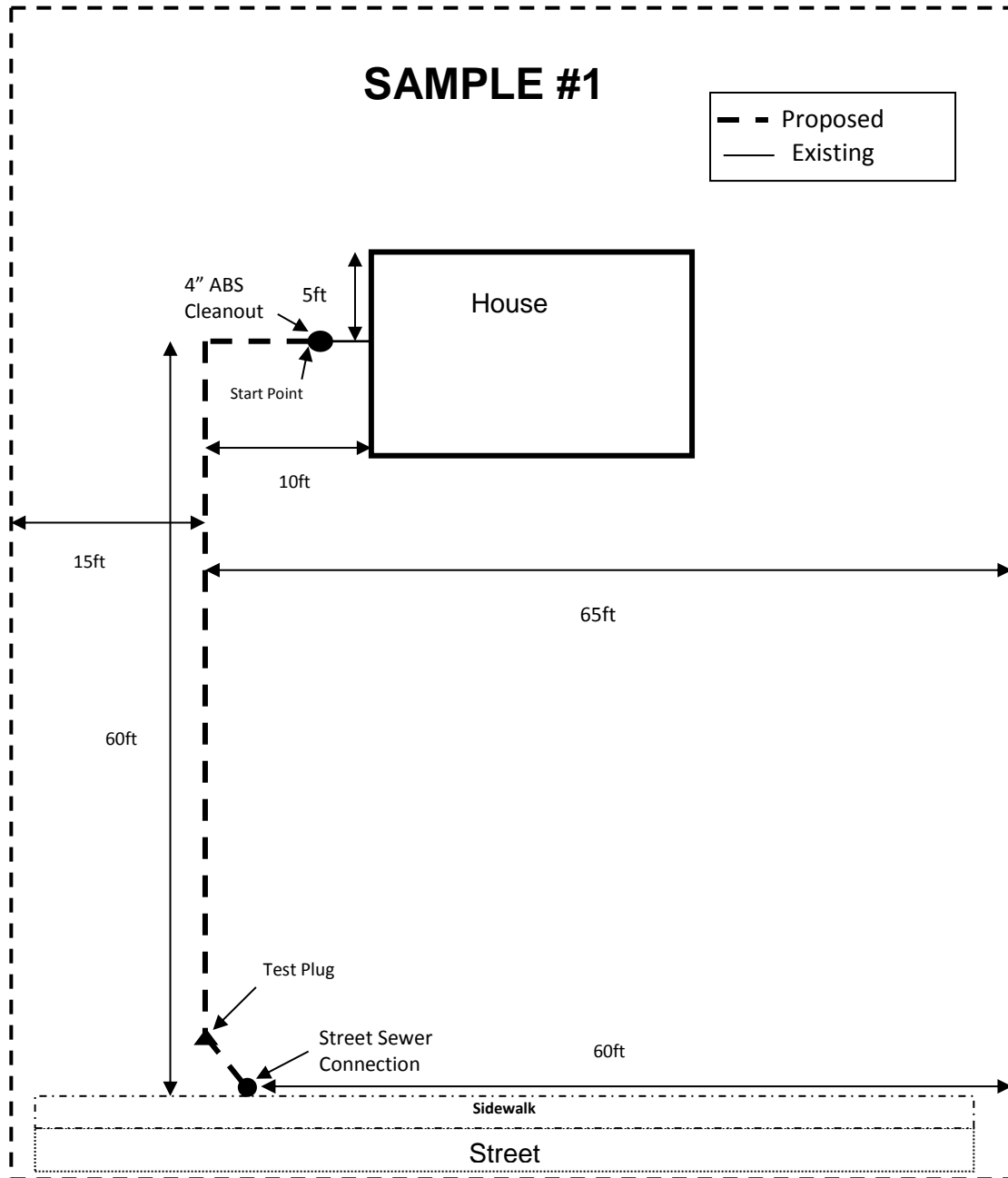

\* Dimensions of existing sewer lateral

Length	Diameter
60'	4"

\* Type of pipe

ABS
-----

\* Depth of pipe at household

2'
----

\* Depth of pipe mid-yard

4'
----

\* Depth of sewer lateral connection

6'
----

\* Dimension of new sewer lateral

Length	Diameter
60'	4"

\* Type of new lateral

ABS
-----

\* Dimension of street sewer main

Diameter
6"

\*Type of pipe

CLAY
------

\* Depth of sewer main at street

6'
----



**Please draw on the sample site plan below:**

- Existing sewer pipe (lateral) line location, new sewer lateral or section location, location of spot of repair, backwater valve location, cleanout and location of street connection.
- Provide dimensions of lateral from fixed structures and/or property line (Ex. house, street, property line, curb)

*Note: Backwater valve may be required depending on location of street upper main sewer man hole.*

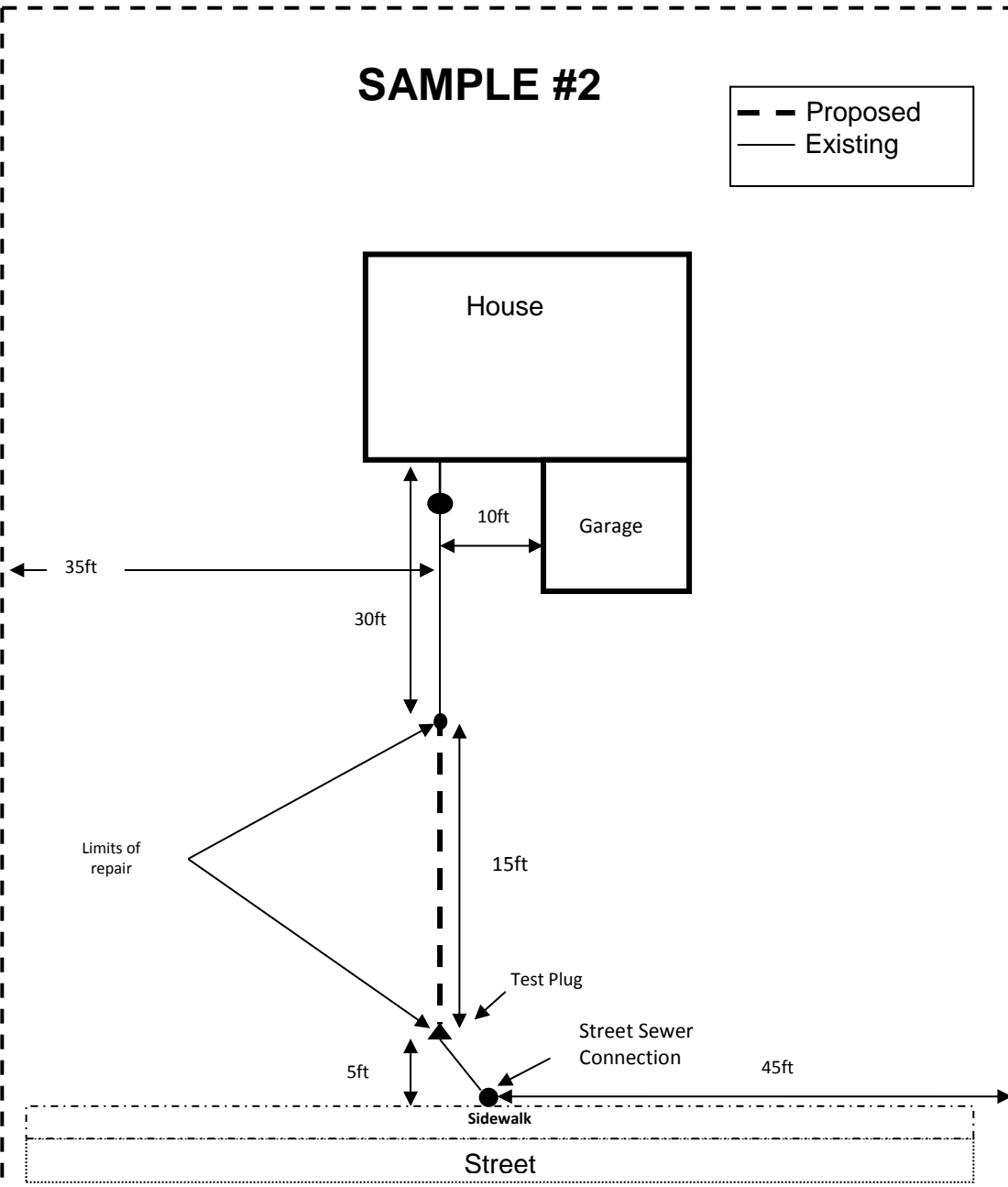

**\* Dimensions of existing sewer lateral**

Length	Diameter
50'	4"

**\* Type of pipe**

CLAY
------

**\* Depth of pipe at household**

2'
----

**\* Depth of pipe mid-yard**

4'
----

**\* Depth of sewer lateral connection**

6'
----

**\* Dimension of new sewer lateral**

Length	Diameter
15'	4"

**\* Type of new lateral**

ABS
-----

**\* Dimension of street sewer main**

Diameter
6"

**\*Type of pipe**

CLAY
------

**\* Depth of sewer main at street**

6'
----



Please draw on the sample site plan below:

- Existing sewer pipe (lateral) line location, new sewer lateral or section location, location of spot of repair, backwater valve location, cleanout and location of street connection.
- Provide dimensions of lateral from fixed structures and/or property line (Ex. house, street, property line, curb)

*Note: Backwater valve may be required depending on location of street upper main sewer man hole.*

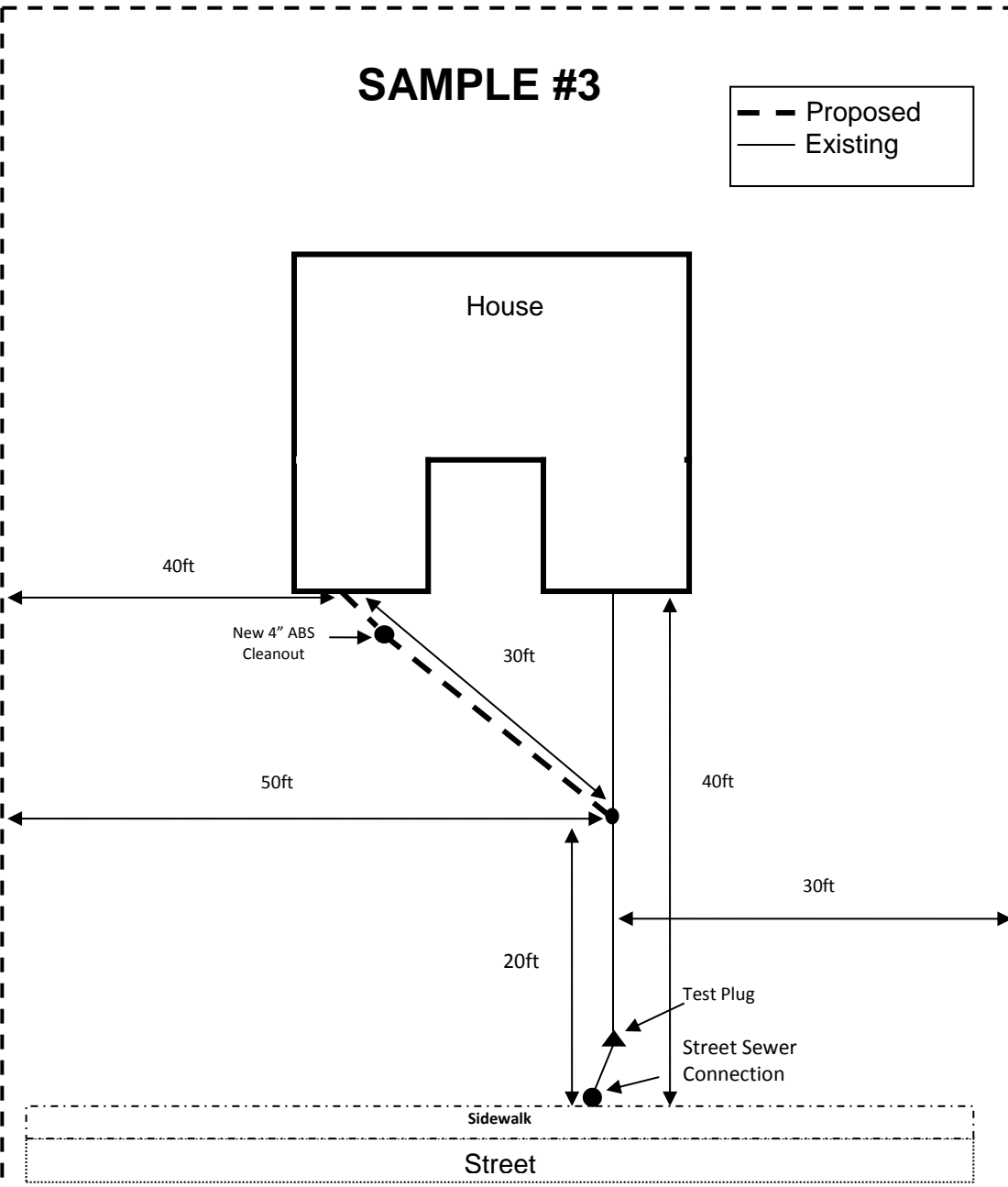

\* Dimensions of existing sewer lateral

Length	Diameter
40'	4"

\* Type of pipe

ABS
-----

\* Depth of pipe at household

3'
----

\* Depth of pipe mid-yard

4'
----

\* Depth of sewer lateral connection

6'
----

\* Dimension of new sewer lateral

Length	Diameter
30'	4"

\* Type of new lateral

ABS
-----

\* Dimension of street sewer main

Diameter
6"

\*Type of pipe

CLAY
------

\* Depth of sewer main at street

6'
----